

Tools to use:

6. Phillips screwdriver.
7. 3.5mm drill bit.
8. Pop-rivet gun & rivets to suit 3.5mm.
9. File.
10. Electric drill.

At the correct height for positioning of the lock box.

Cut the frame to suit the lock mounting for **85mm** as shown.

Seam weld this into position in area's shown by **A** on both side of the box. Insert lock the box, and as a guide insert the cylinder marked **C** into position. Then tighten this into position with the cylinder screw marked **D**. Mark hole positions, two points marked **B**. Remove cylinder and lock. Drill the two pilot holes 3.5mm to screw or pop rivet lock into position on the frame.

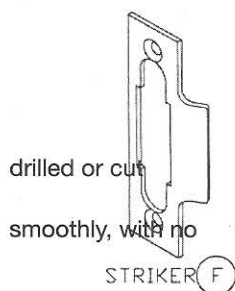
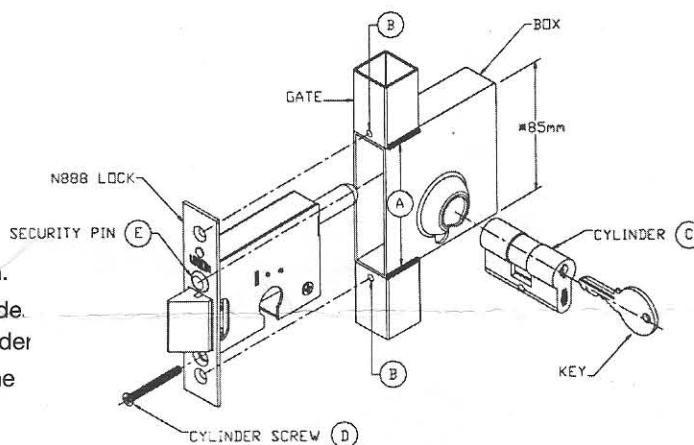

Lock the security pin marked **E** and close the gate. Using this as a guide, mark of the area to be out on the outer frame. Leaving enough space for the locking mechanism of the lock to work

interference. Place the striker marked **F** into position. Mark off the two holes, to again either screw

Part No. L889034 Custom Printing Services (011) 900-3603



Reversing of spring bolt of a N888 security gate lock

Tools to use:

2. Phillips screwdriver.

Reversing of Spring bolt head.

(NB: check gate prior to installation for left handing or fight handing swing.)

To reverse the spring bolt for a left or right hand door, do the following

Figure A: Using a Phillips screwdriver, remove the two screws marked **1** by pushing the spring bolt head slightly back. Pull out the spring bolt head marked **1a**.

Figure B: Turn the spring bolt head through **180°**

Figure C: Push head marked **2** back into the lock, inserting the groove of the head into the lath. Line up the holes between the head and the lath.

Figure D: Re-insert the screws marked **4** back into position and tighten screws into the fixed position.

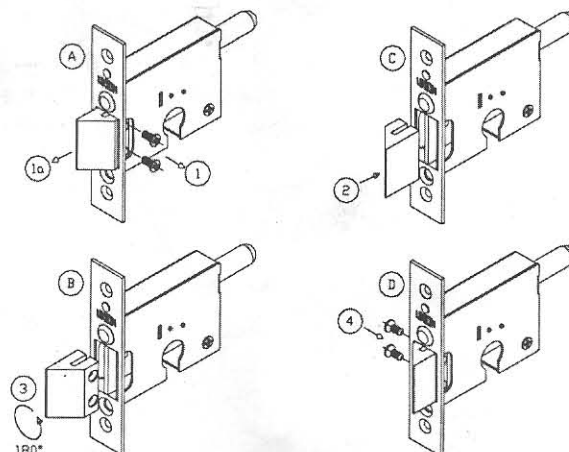

This now completes the reversing of the spring bolt head.